

STA 13+680

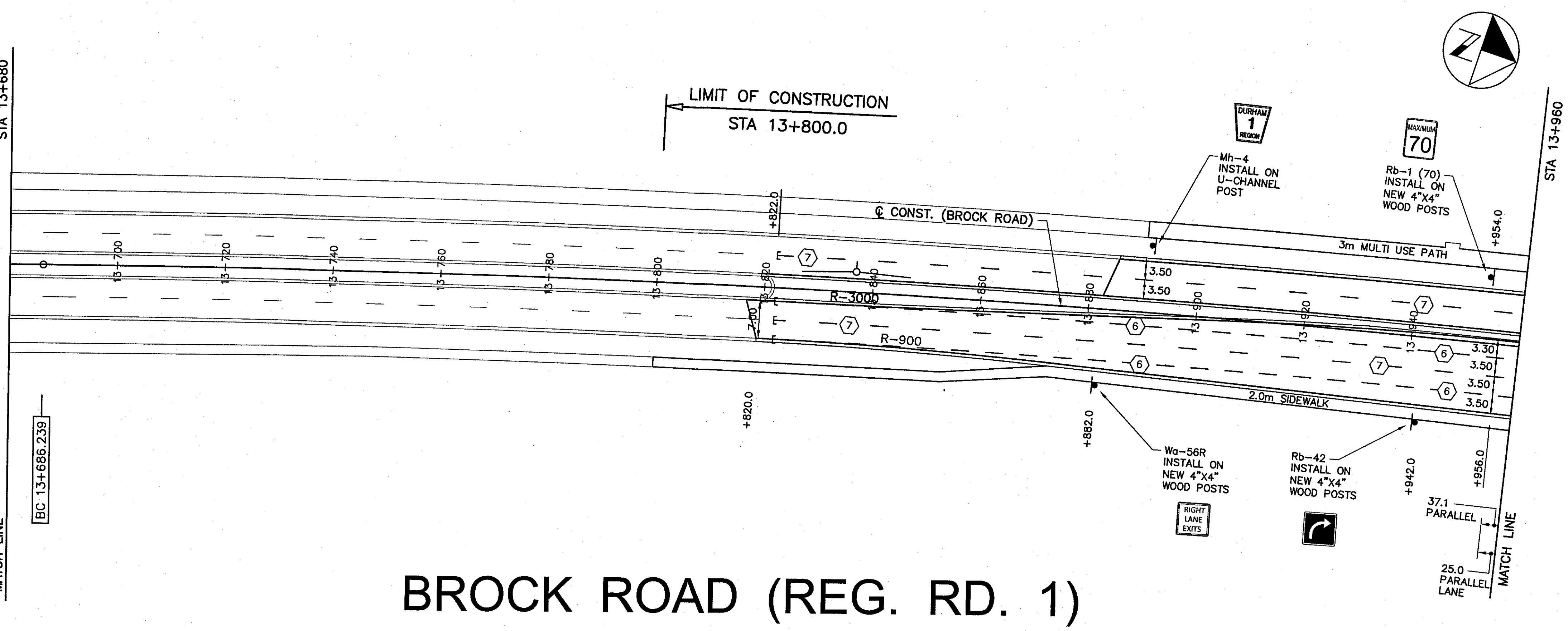

# BROCK ROAD (REG. RD. 1)

PAVEMENT MARKING LEGEND			
IDENTIFICATION	TYPE	COLOUR	WIDTH (cm)
1	SOLID	YELLOW	10
2	DOUBLE SOLID	YELLOW	10
3	3-6-3 BROKEN	YELLOW	10
4	SOLID:3-6-3 BROKEN	YELLOW	10
5	SOLID	WHITE	10
6	3-3-3 BROKEN	WHITE	10
7	3-6-3 BROKEN	WHITE	10
8	3-9-3 BROKEN	WHITE	10
9	SOLID	WHITE	20
10	1-1-1 BROKEN	WHITE	20
11	3-3-3 BROKEN	WHITE	20
12	3-3-3 BROKEN	WHITE	30
13	SOLID	WHITE	30
14	SOLID	WHITE	45
15	SOLID	WHITE	60
16	1-1-1 BROKEN	WHITE	10
20	SYMBOLS	-	-
] OR [ LIMITS OF MARKINGS			

- PAVEMENT MARKING DENOTATIONS :**
- 3-3-3, 3-6-3, 3,9,3; LINE-GAP-LINE SPACING IN METRES
  - ① PERMANENT
  - ① TEMPORARY
  - ▽ TEMPORARY-REMOVABLE
  - ① DURABLE
  - ◆ EXISTING MARKING TO BE REMOVED OR (TREATED?)
- NOTES :**
- ALL MARKINGS AND SIGNS SHALL CONFORM WITH THE ONTARIO TRAFFIC MANUAL (OTM) BOOK 11.
  - PROPOSED MARKINGS TO MATCH EXIST. AT ALL WORK AND/OR ROAD RECONSTRUCTION LIMITS.
  - LONGITUDINAL MARKINGS - PAINT ON BASE COURSE AND PLASTIC ON TOP COURSE.
  - TRANSVERSE MARKINGS - SYMBOLS PLASTIC ON BOTH BASE AND TOP COURSE.
  - SIGN MOUNTING HEIGHTS, AND LATERAL OFFSETS SHALL BE IN ACCORDANCE WITH THE ONTARIO TRAFFIC MANUAL (OTM) BOOK 1B, SECTION 12.

NO.	DATE	NAME	REVISIONS



AECOM Canada Ltd.  
300 Water Street, Whitby, Ontario, Canada L1N 9J2  
T905.668.9363 F905.668.0221

This drawing has been prepared for the use of AECOM's client and may not be used, reproduced or relied upon by third parties, except as agreed by AECOM and its client, as required by law or for use by governmental reviewing agencies. AECOM accepts no responsibility, and denies any liability whatsoever, to any party that modifies this drawing without AECOM's express written consent.

Do not scale this document. All measurements must be obtained from stated dimensions.

UTILITIES VERIFIED			
ROGERS CABLE	2007 04 26	HYDRO ONE	2007 07 2
BELL CANADA	2007 05 10	CITY OF PICKERING	XXXX XX X
ENBRIDGE GAS	2012 03 01	VERIDIAN CONNECTIONS	2007 06 0

CONTRACTOR TO BE RESPONSIBLE FOR LOCATION OF ALL EXISTING U/G & OVERHEAD UTILITIES. VARIOUS UTILITIES REQUIRE ADVANCE NOTICE PRIOR TO DIGGING, FOR STAKE OUT. THE REGION ASSUMES NO RESPONSIBILITY FOR THE ACCURACY OF THE LOCATION OF EXISTING UTILITIES AS INDICATED ON THIS DRAWING.

BRIAN E. RUCK  
XXXX/XXXX  
PROVINCE OF ONTARIO

J. Z. WICZOREK  
XXXX/XXXX  
PROVINCE OF ONTARIO

SURVEY DATA DATE  
2008 06 06

SCALE  
HORIZONTAL 1:10  
VERTICAL 1:10

DRAWN: E. MEIJERINK	DATE: 2012 05
DESIGN: R. AUGER	DATE: 2012 05
CHECKED: J. WICZOREK	DATE: 2012 05
APPROVED: B. RUCK	DATE: 2012 05

**THE REGIONAL MUNICIPALITY OF DURHAM**

WORKS DEPARTMENT

WHITBY ONTARIO

BROCK ROAD (REG. RD. 1)		
PAVEMENT MARKINGS		
FROM 365m S. OF ROSSLAND RD. TO 195m N. OF ROSSLAND RD.		
CONCESSION	REG. RD. NO.	AREA MUNICIPALITY
2 & 3	1	CITY OF PICKERING
DRAWING NUMBER	CONTRACT NUMBER	SHEET NUMBER
PM-07	D2012-006	53 OF 100

NOTE: ALL DIMENSIONS ARE IN METRES UNLESS OTHERWISE NOTED.

STA 13+960

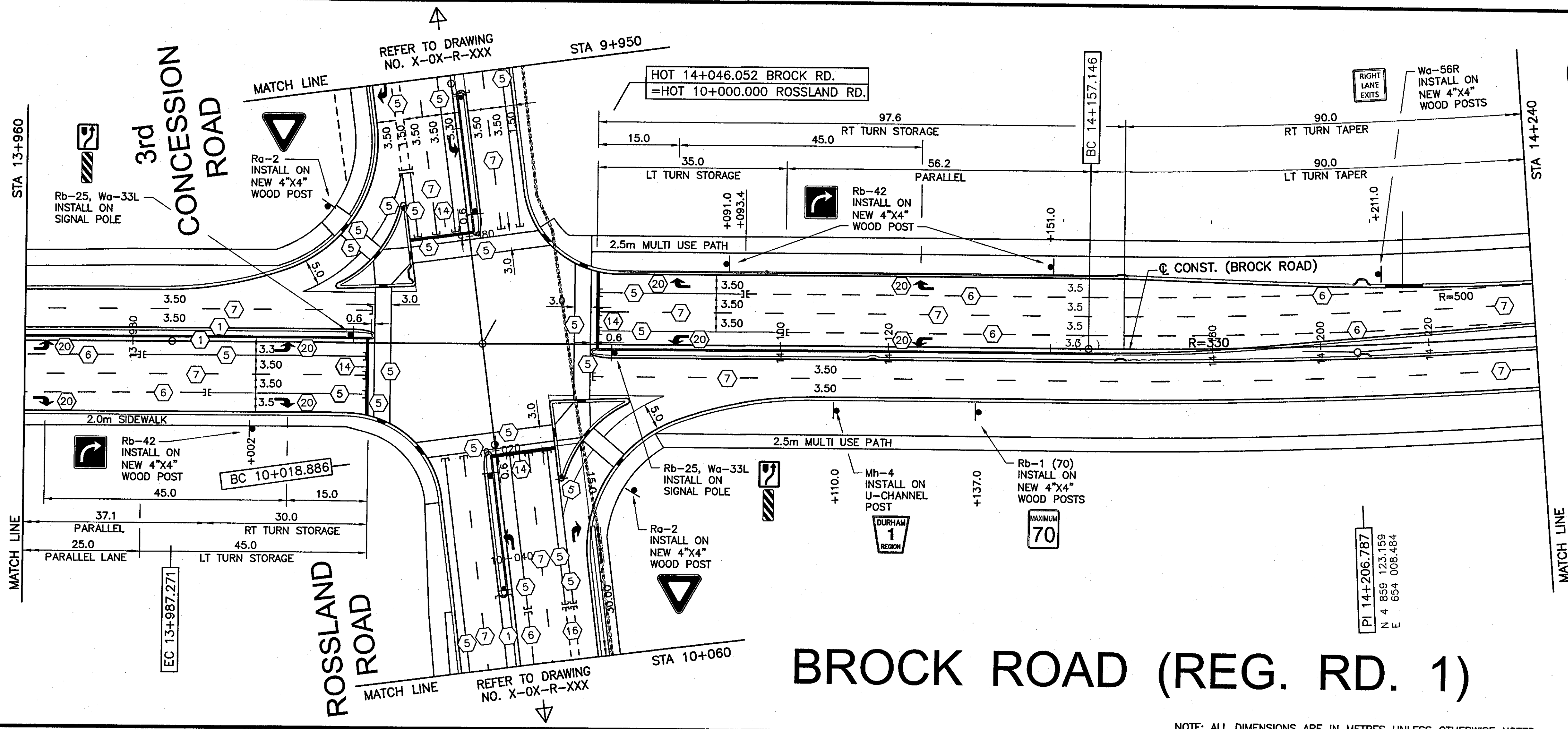

# BROCK ROAD (REG. RD. 1)